

RREF

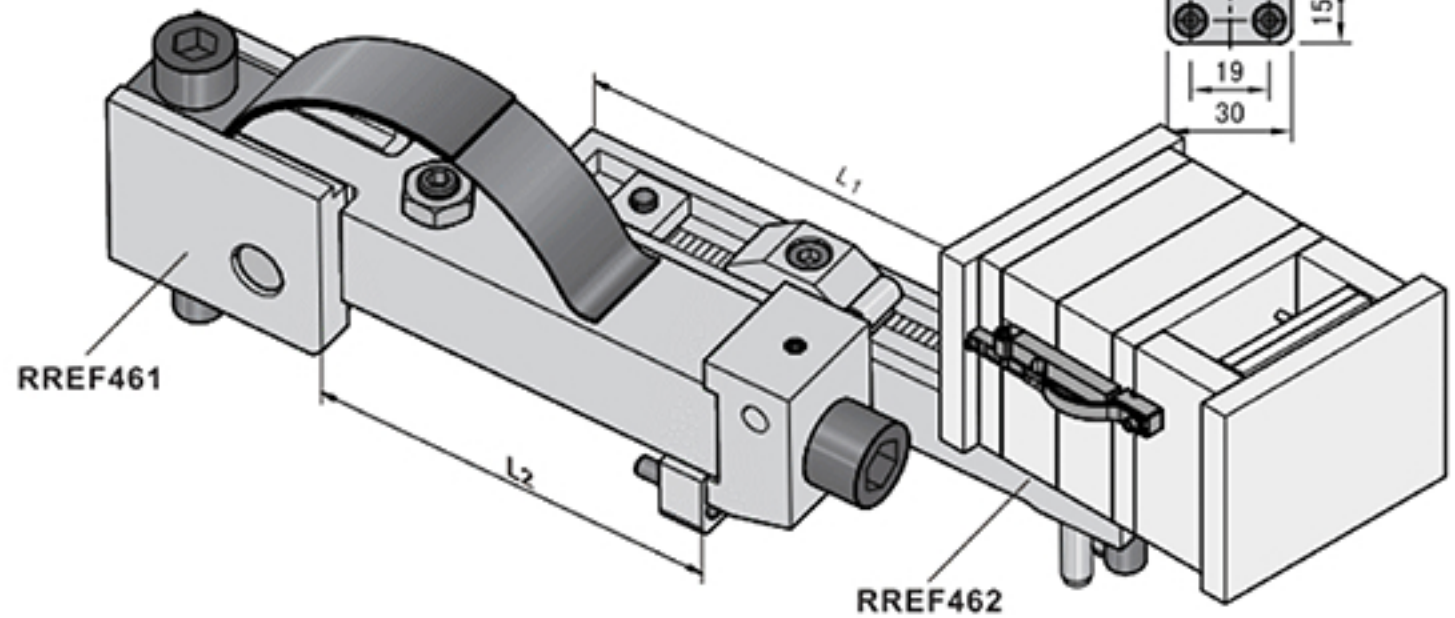
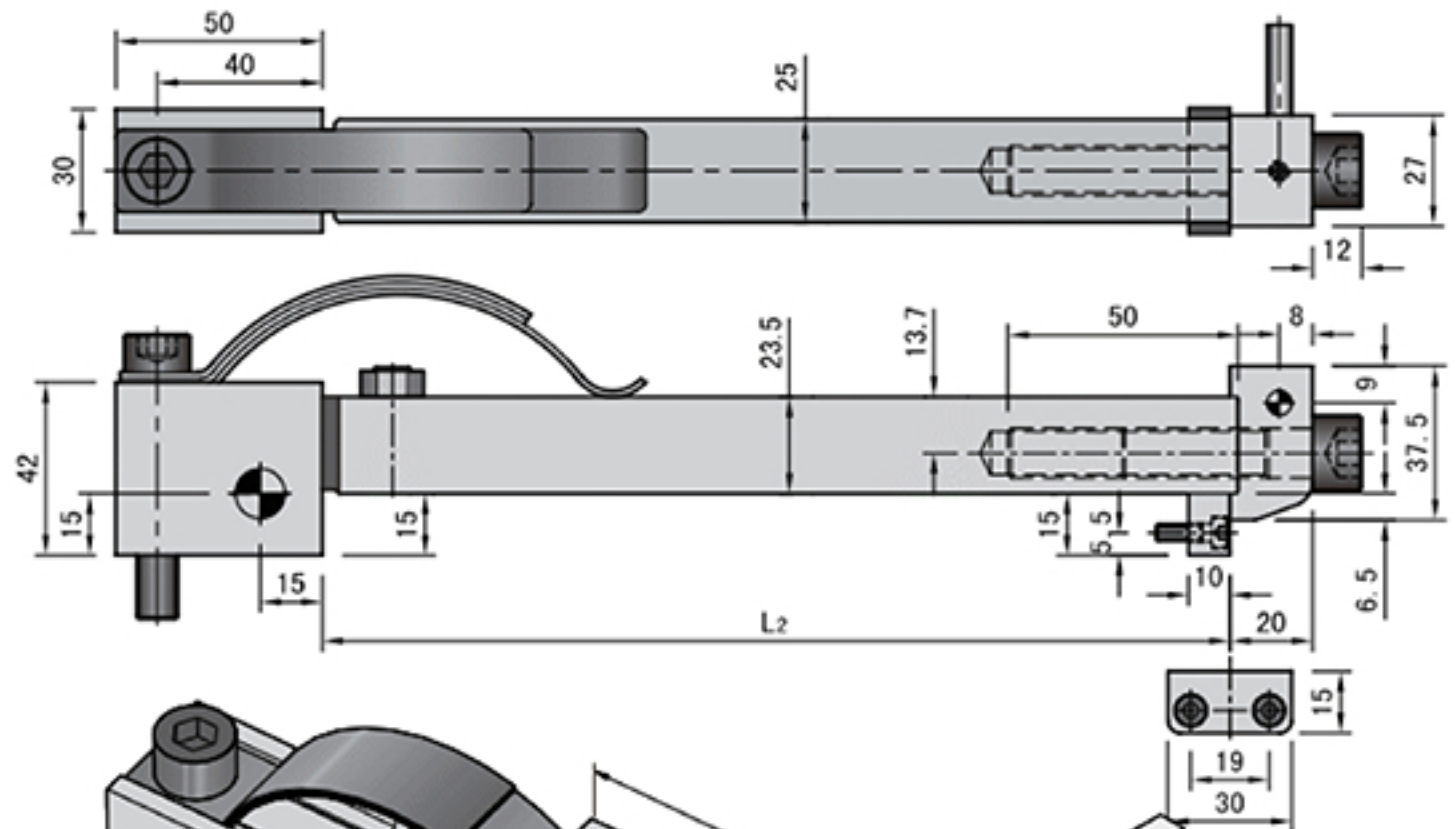
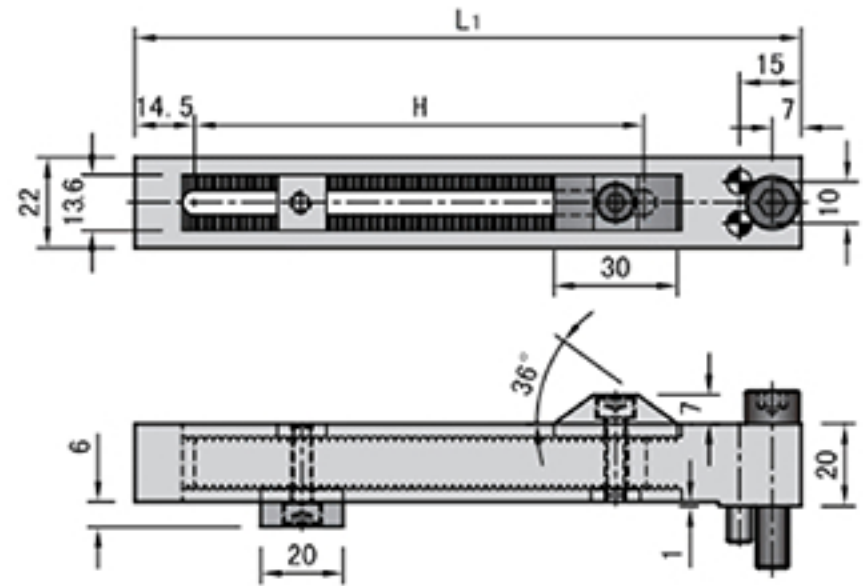

Order RREF460-140-90

=

Order RREF462-140

+

Order RREF461-90

Code	L1	H	L2	Code	L1	H	@ ¥/P	Code	L2	@ ¥/P
RREF460-140-90	140	83.5	90	RREF462-140	140	83.5		RREF461-90	90	
RREF460-204-170	204	152	170	RREF462-204	204	152		RREF461-170	170	
RREF460-254-220	254	194.5	220	RREF462-254	254	194.5		RREF461-220	220	



1. The part of stroke adjustable adopt dental saw design , save dowel pin holes process, at the same simplify stroke adjustable.
2. Unque shrapnel design , safety and reliable ,and easy to install .
3. Suggest install latch lock on left and right two sides of mould , Due to weight problem of products , if install on top and low two sides will impact locking force.
4. More sets latch lock mechanism install must be sure same stroke , otherwise will cause latch lock break due to imbalance force.
5. When use it , frequently to check up various installed screw whether fastening or not, if need maintenance and change. Please first remove latch lock device to follow-up operation.

Product space chart:

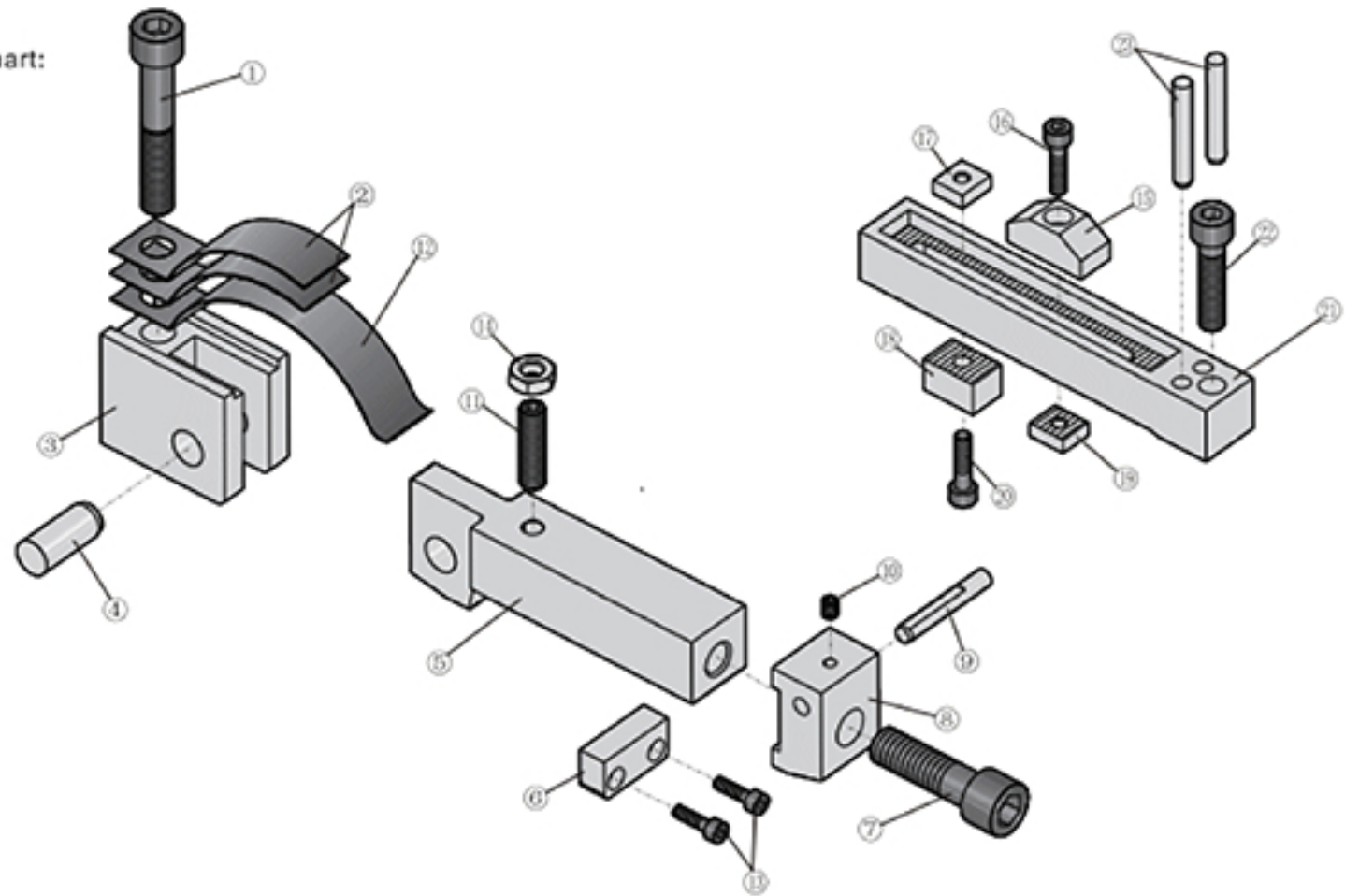

Pos	1	4	7	9	11	13	14	16	20	22	23
	M10×60	Ø12×30	M12×40	Ø12×40	M8	M4×14	M8	M5×20	M5×20	M8×35	Ø6×40

Pos	1	2	4	10	13	14
	Cr12MoV 58-62HRC	P20 26-33HRC	Cr12MoV 55-58HRC	SKD61 52±2HRC	SKD11 55-58HRC	P20 26-33HRC

Code	RREF460																						
	RREF461														RREF462								
Pos	01	02	03	04	05	06	07	08	09	10	11	12	13	14	15	16	17	18	19	20	21	22	23
(Pcs)	1	2	1	1	1	1	1	1	1	1	1	1	2	1	1	1	1	1	1	1	1	1	2

