

Typ1

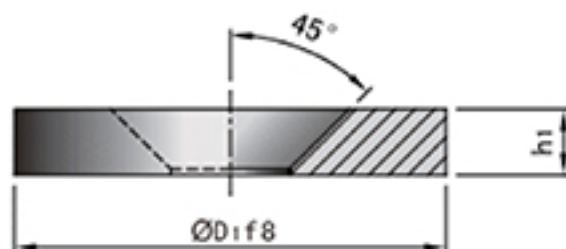

Typ2

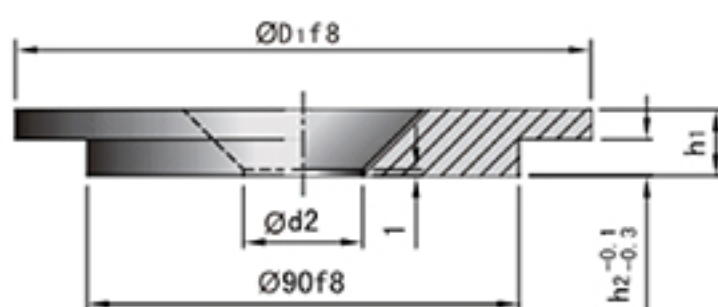

Typ3



KK100

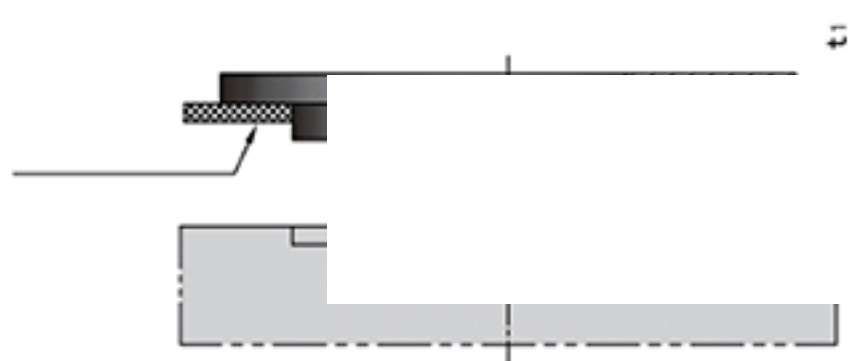

Order KK100-D1-h1 M :S45C

D1	h1	h2	D2	t1	Typ	@ ¥/P
60	11	7	26	3	1	
	13	9		5		
80	11	7		3		
	13	9		5		
90	11	-	36	3	2	
	13			5		
	15			7		
	16.5			8.5		
100	11	7		3	3	
	13	9		5		
	15	11		7		
	16.5	12.5		8.5		
110	11	7		3		
	13	9		5		
	15	11		7		
	16.5	12.5		8.5		
120	11	7		3		
	13	9		5		
	15	11		7		
	16.5	12.5		8.5		
125	11	7		3		
	13	9		5		
	15	11		7		
	16.5	12.5		8.5		
160	11	7		3		
	13	9		5		
	15	11		7		
	16.5	12.5		8.5		
175	11	7		3		
	13	9		5		
	15	11		7		
	16.5	12.5		8.5		

