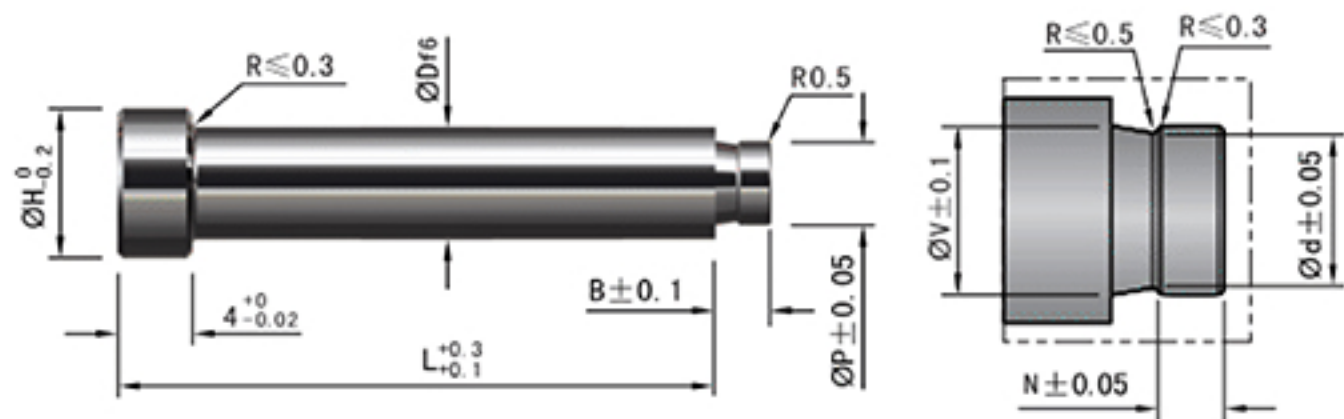

**RRLHB  
RRLHG**

 Order RRLHB-D-L-P-d-V **M** :SKH51 **H** :58-60HRC

Code	D	H	B	N	0.1mm		
					P	d	V
RRLHB	2	4	2	1	1.3-1.9	0.8-1.4	$d \leq V < D$
	3	5	2	1	1.3-2.9	0.8-2.4	
	4	6	2.5	1	1.5-3.9	1 -3.4	
	5	7	3	1.5	1.7-4.9	1.2-4.4	
	6	8	3	1.5	2 -5.9	1.5-5.4	
	8	10	4	2	2.5-7.9	2 -7.4	
	10	13	5	2.5	3 -9.9	2.5-9.4	

 $P-d \geq 0.5$ 

D	@ ¥ / P 0.1mm												
	L14	L19	L25	L30	L35	L40	L45	L50	L60	L70	L80	L90	L100
2													
3													
4													
5													
6													
8	-												
10													

 Order RRLHG-D-L-P-d-V **M** :SKH51 **H** :58-60HRC

Code	D	H	B	N	0.1mm		
					P	d	V
RRLHG	2	4	2	1	1.3-1.9	0.8-1.4	$d \leq V < D$
	3	6	2	1	1.3-2.9	0.8-2.4	
	4	7	2.5	1	1.5-3.9	1 -3.4	
	5	8	3	1.5	1.7-4.9	1.2-4.4	
	6	9	3	1.5	2 -5.9	1.5-5.4	
	8	11	4	2	2.5-7.9	2 -7.4	
	10	15	5	2.5	3 -9.9	2.5-9.4	

 $P-d \geq 0.5$ 

D	@ ¥ / P 0.1mm												
	L14	L19	L25	L30	L35	L40	L45	L50	L60	L70	L80	L90	L100
2													
3													
4													
5													
6													
8	-												
10													

