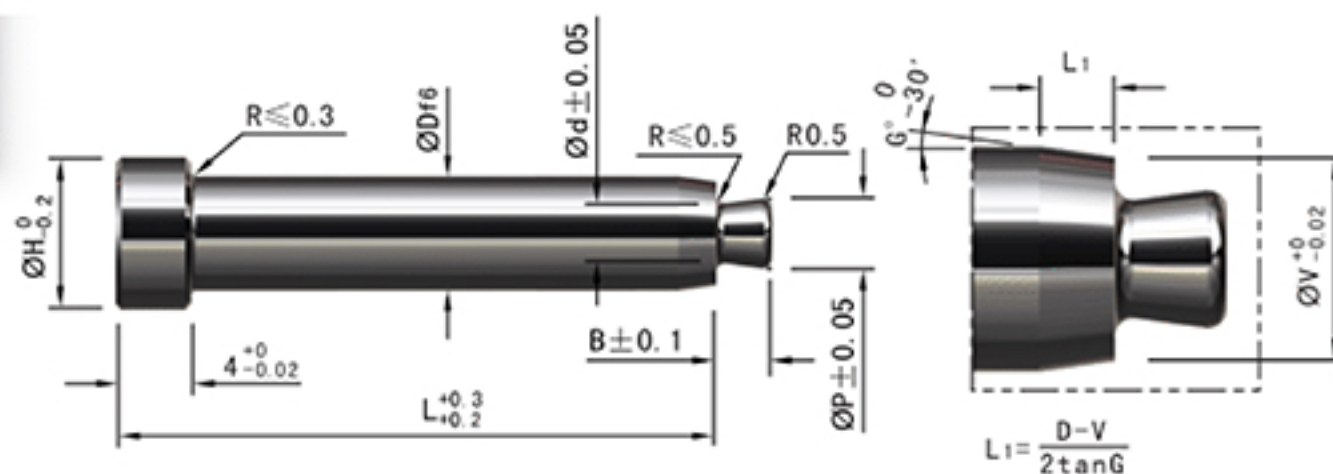

**RRLTB  
RRLTG**

 Order RRLTB-D-L-P-d **M** :SKH51 **H** : 58-60HRC

Code	D	H	B	G°	V	0.1mm	
						P	d
RRLTB	3	5	2	5	2.5	0.9-2.1	0.8-2
	4	6	2.5		3	1.1-2.4	1 -2.3
	5	7	3		3.5	1.3-2.8	1.2-2.7
	6	8			4	1.6-3.3	1.5-3.2
	8	10	4		6	2.1-5.2	2 -5.1
	10	13	5		8	2.6-7	2.5-6.9

D	@ V/P 0.1mm												
	L20	L25	L30	L35	L40	L45	L50	L55	L60	L70	L80	L90	L100
3													
4													
5													
6													
8	-												
10													

 Order RRLTG-D-L-P-d **M** :SKH51 **H** : 58-60HRC

Code	D	H	B	G°	V	0.1mm	
						P	d
RRLTG	3	-	2	5	2.5	0.9-2.1	0.8-2
	4	7	2.5		3	1.1-2.4	1 -2.3
	5	8	3		3.5	1.3-2.8	1.2-2.7
	6	9			4	1.6-3.3	1.5-3.2
	8	11	4		6	2.1-5.2	2 -5.1
	10	15	5		8	2.6-7	2.5-6.9

D	@ V/P 0.1mm												
	L20	L25	L30	L35	L40	L45	L50	L55	L60	L70	L80	L90	L100
3													
4													
5													
6													
8	-												
10													

